

Topic: Editing Timeline / Cutting Video

In the newest version of Panopto, editing videos has become easier and faster. Learn how to use the Editing Timeline/Cutting Tool in Panopto:

Edit Timeline Tool

The Edit Timeline tool allows you to cut out parts of the video that you do not wish to be shown anymore. If you have an error, you wish to cut out:

1. After logging into Panopto and locating to your video, click Edit under the video link to access and edit your video.

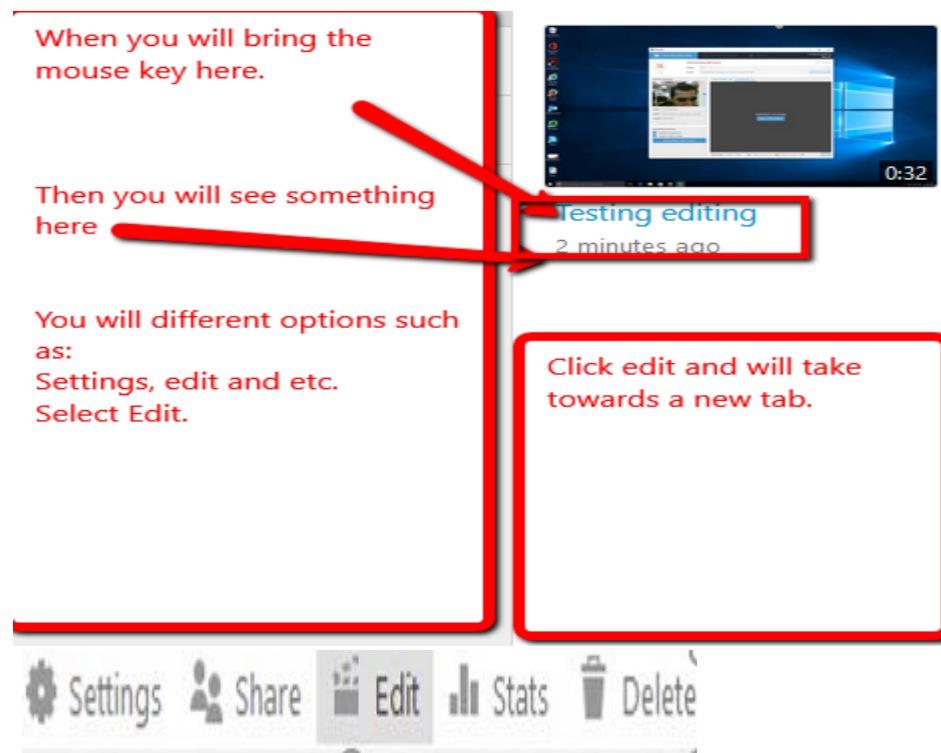

2. Now you will have a page similar to this. Click the edit timeline tool (the scissor icon)

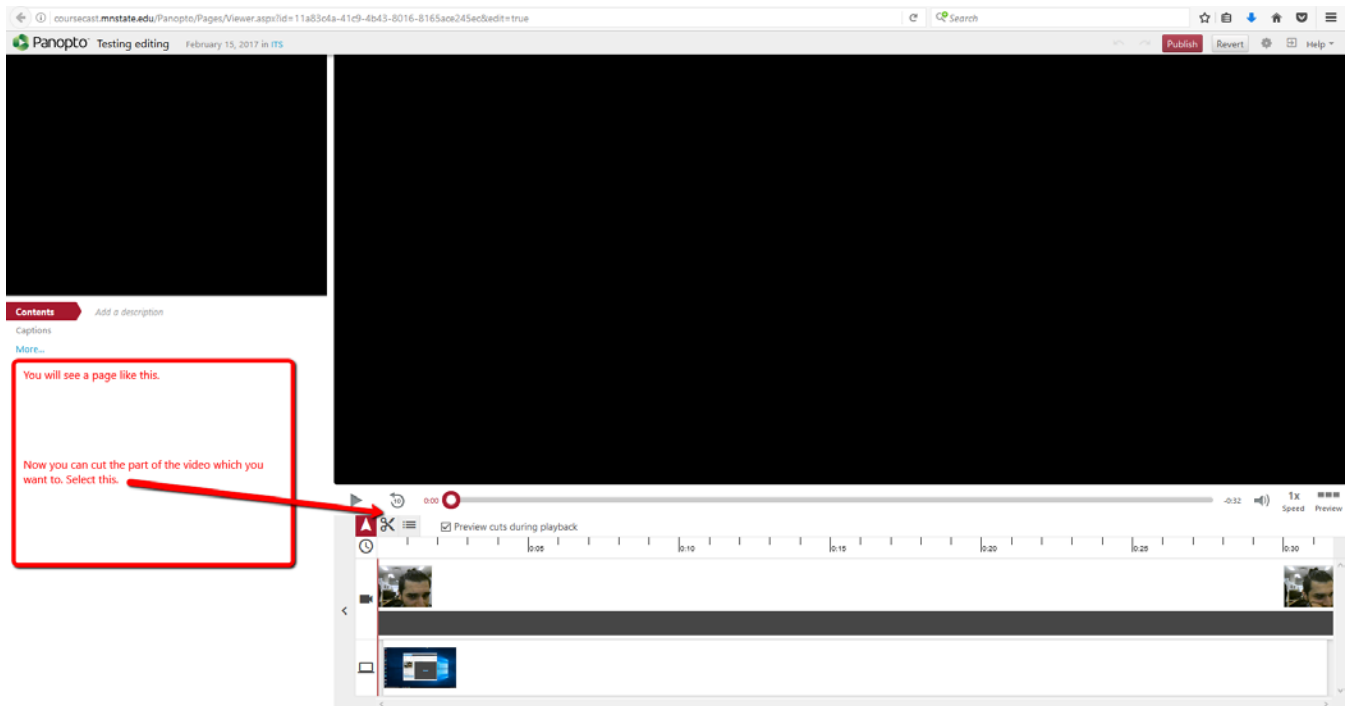

3. Once you have selected scissor, click the start point of the cut you wish to make

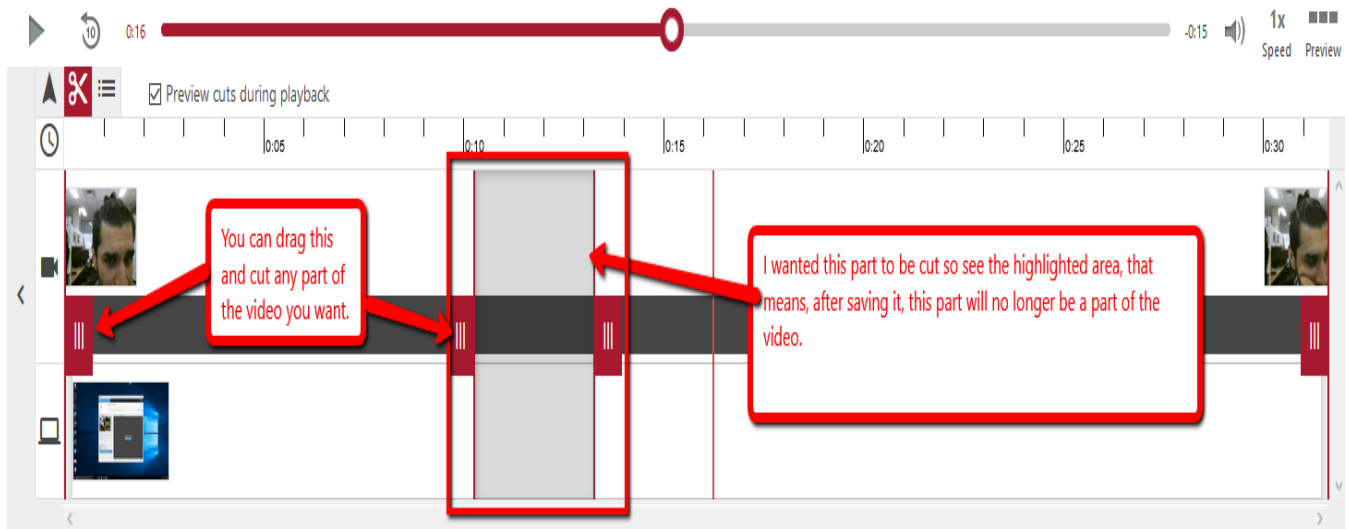

4. To remove a cut, drag the handle to the other handle.

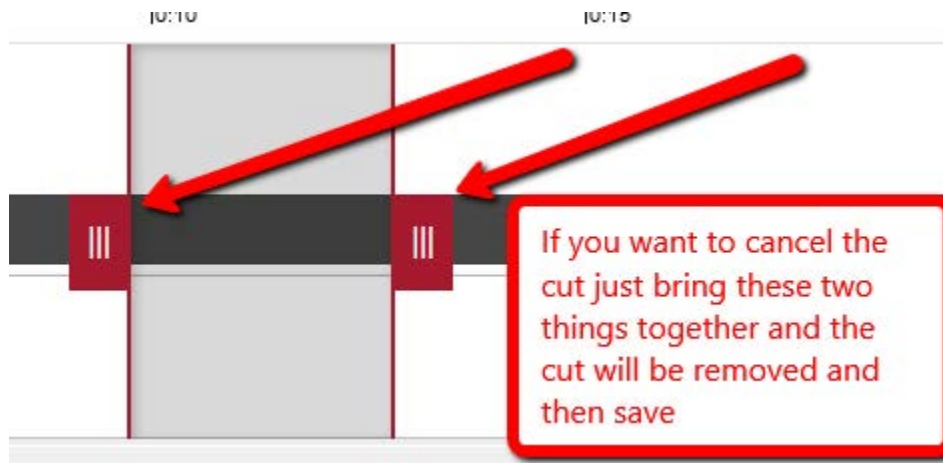

5. Click **Publish** located on the top right of the editing page when done.

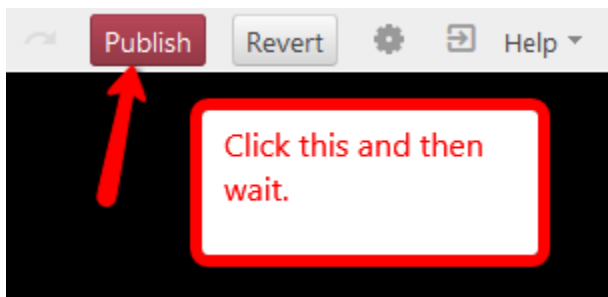

For More Information

Please contact Instructional Technology Services at support@mnstate.edu or 218.477.2603 if you have questions about this material.

